

Luminaire A Data			Luminaire B Data		
Type	Vestibule Metro Streetlight 19W LED Street Optic R03	Type	Vestibule Metro Streetlight 19W LED Forward Throw A Optic		
Lamp(s)	BLEED 3,000K G4	Lamp(s)	BLEED 3,000K G4		
Lamp Flux (lm)	2,25	Lamp Flux (lm)	2,24		
File Name	SMTA08LGA.R03.es	File Name	SMTA08LGA.FTA.es		
Maintenance Factor	0.85	Maintenance Factor	0.85		
Imax 70.80(0000mm)	537.8 56.5 0.3	Imax 70.80(0000mm)	401.3 47.0 0.5		
No. in project	33	No. in project	13		

Calculation Summary						
Description	Ev	Emax	Emin	Emin/Ev	Emin/Emax	Emax/Ev
Road & Paths	5.52	18.33	1.08	0.20	0.06	3.32

- Notes:
- To NCE scale from this drawing
 - The actual results achieved may vary from predicted values due to normal deviation in luminaire installation, electrical supply, equipment tolerances, observations including poles, brackets and mounting arms, reflectors etc.
 - This design is based on a preliminary assessment only and will be developed during the detailed design stage.

Symbol	Description
○	Luminaire A Column
●	Luminaire B Column
○	Beam Aiming Target
□	Photometric Centre

ID	Type	X	Y	Height	Angle	Tilt	Cont	Outs
1	A	359.80	189.42	6.00	236.00	0.00	0.00	0.00
2	A	349.01	223.76	6.00	211.00	0.00	0.00	0.00
3	B	318.62	249.23	6.00	303.00	0.00	0.00	0.00
4	A	347.33	258.13	6.00	118.00	0.00	0.00	0.00
5	B	305.95	239.84	6.00	297.00	0.00	0.00	0.00
6	A	274.46	225.03	6.00	304.00	0.00	0.00	0.00
7	A	251.95	252.46	6.00	115.00	0.00	0.00	0.00
8	A	326.51	212.30	6.00	41.00	0.00	0.00	0.00
9	A	327.71	222.19	6.00	269.00	0.00	0.00	0.00
10	A	220.92	195.60	6.00	306.00	0.00	0.00	0.00
11	A	253.65	171.21	6.00	152.00	0.00	0.00	0.00
12	A	190.21	167.57	6.00	307.00	0.00	0.00	0.00
13	A	180.53	178.70	6.00	37.00	0.00	0.00	0.00
14	A	176.39	145.99	6.00	319.00	0.00	0.00	0.00
15	A	154.97	121.48	6.00	324.00	0.00	0.00	0.00
16	A	134.87	179.82	6.00	278.00	0.00	0.00	0.00
17	A	138.85	166.20	6.00	222.00	0.00	0.00	0.00
18	A	117.23	150.30	6.00	337.00	0.00	0.00	0.00
19	B	97.21	112.85	6.00	218.00	0.00	0.00	0.00
20	B	89.80	54.77	6.00	142.00	0.00	0.00	0.00
21	B	79.61	76.60	6.00	147.00	0.00	0.00	0.00
22	A	54.09	36.40	6.00	499.00	0.00	0.00	0.00
23	A	50.77	133.74	6.00	174.00	0.00	0.00	0.00
24	A	50.51	148.16	6.00	179.00	0.00	0.00	0.00
25	A	154.98	153.37	6.00	344.00	0.00	0.00	0.00
26	A	159.15	167.57	6.00	209.00	0.00	0.00	0.00
27	A	114.92	131.25	6.00	135.00	0.00	0.00	0.00
28	A	107.45	171.46	6.00	240.00	0.00	0.00	0.00
29	B	85.40	199.73	6.00	106.00	0.00	0.00	0.00
30	B	102.39	189.69	6.00	105.00	0.00	0.00	0.00
31	B	129.31	202.85	6.00	108.00	0.00	0.00	0.00
32	B	98.28	214.73	6.00	287.00	0.00	0.00	0.00
33	B	126.03	220.91	6.00	287.00	0.00	0.00	0.00
34	B	153.19	227.43	6.00	287.00	0.00	0.00	0.00
35	A	157.59	208.97	6.00	106.00	0.00	0.00	0.00
36	A	121.44	223.33	6.00	208.00	0.00	0.00	0.00
37	B	167.51	202.27	6.00	37.00	0.00	0.00	0.00
38	A	328.71	236.34	6.00	25.00	0.00	0.00	0.00
39	A	139.67	72.57	6.00	238.00	0.00	0.00	0.00
40	A	159.64	59.38	6.00	143.00	0.00	0.00	0.00
41	A	192.89	129.00	6.00	241.00	0.00	0.00	0.00
42	A	102.98	103.53	6.00	164.00	0.00	0.00	0.00
43	A	51.16	73.11	6.00	35.00	0.00	0.00	0.00
44	A	105.77	159.23	6.00	114.00	0.00	0.00	0.00
45	A	68.57	57.23	6.00	162.00	0.00	0.00	0.00
46	B	85.15	199.68	6.00	180.00	0.00	0.00	0.00

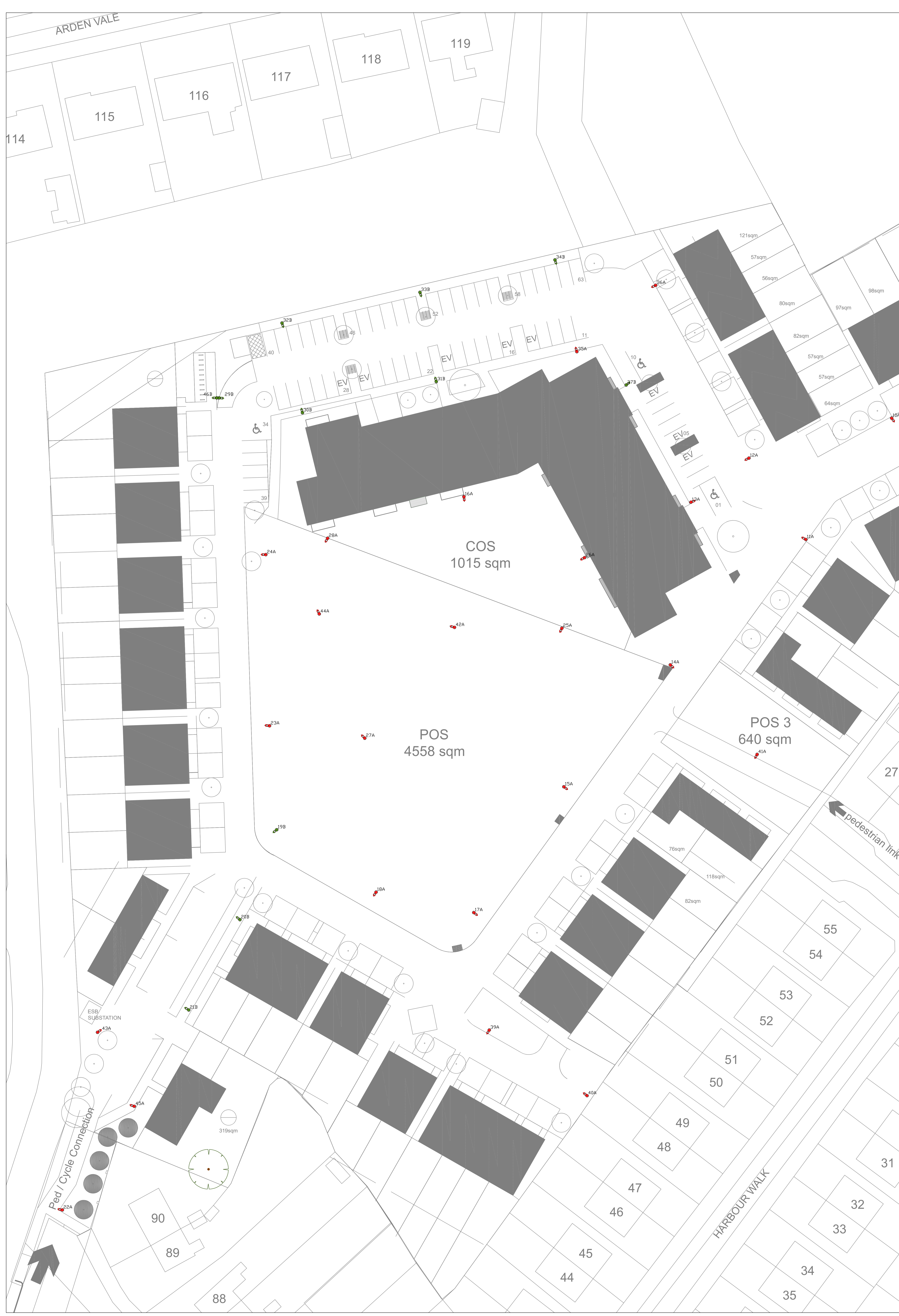

Rev	Description	Date	By
05	Planning Issue	24/04/23	RL
04	Issue for Planning	20/03/23	RL
03	Issue for Planning	02/03/23	RL
02	Photometric Issue	28/02/23	RL
01	Photometric Issue	16/02/23	RL

01 Coffey Consulting Engineering
 0204 A, Macarthur Business Park, Macarthur, NSW 2563
 & 0204 Macarthur Business Park, Macarthur, NSW 2563
 0204 Macarthur Business Park, Macarthur, NSW 2563
 www.coffey-engineering.com.au
 0204 Macarthur Business Park, Macarthur, NSW 2563

Client: John Flanagan Developments
 Site: Wellwood Tullamore
 Title: Public Lighting Layout
 Sheet: 2 of 2
 No. 5251-CCE-XXXX-XX-DR-E01-000100
 Approved: [Signature] Checked: [Signature] Drawn: [Signature]
 Scale: 1:500

Copyright © 2023 Coffey Consulting Engineering. All rights reserved. This drawing is the property of Coffey Consulting Engineering and is not to be reproduced or used for any other purpose without the written consent of Coffey Consulting Engineering.